

SCALE
PURPC

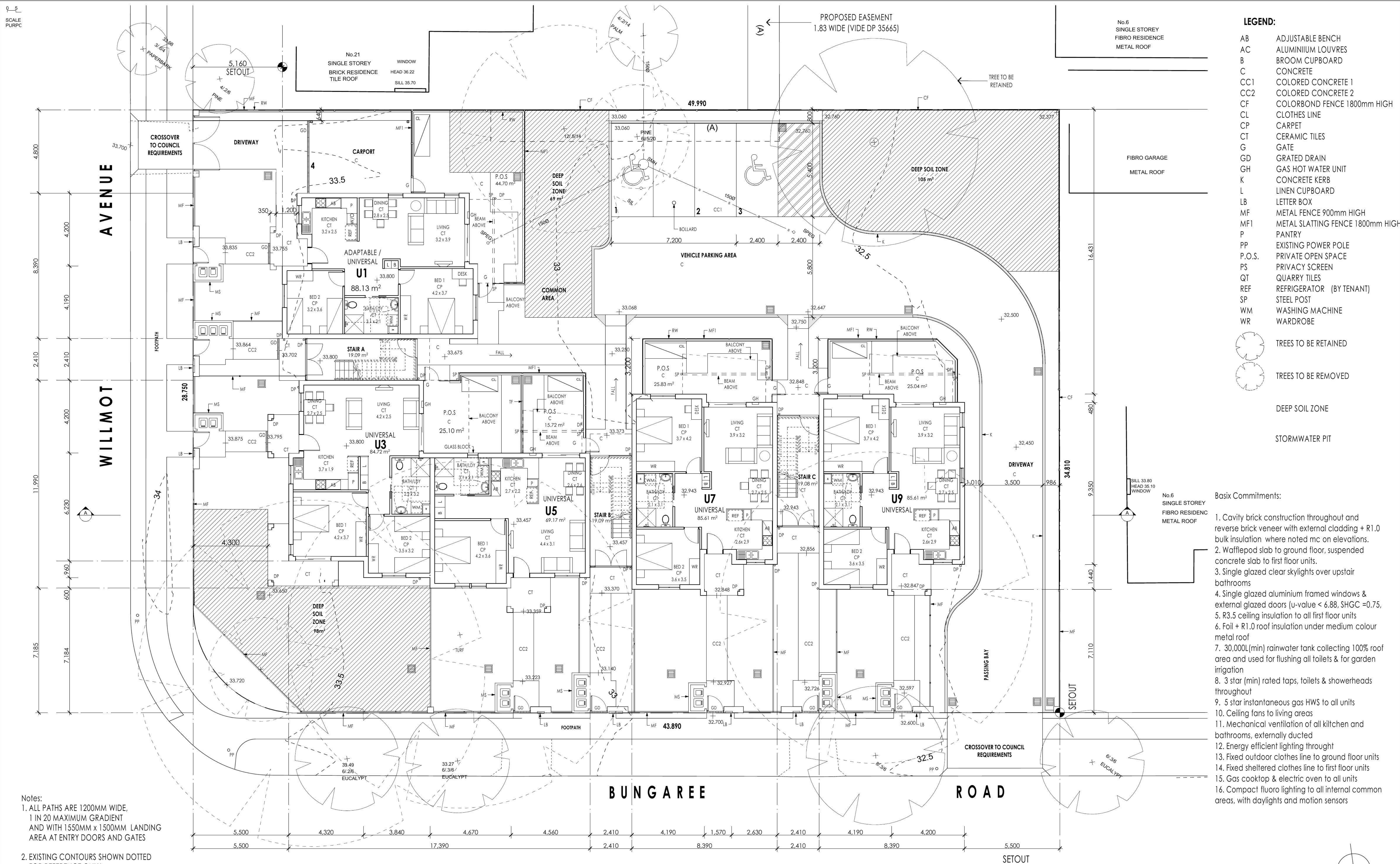

Notes:
1. ALL PATHS ARE 1200MM WIDE,
1 IN 20 MAXIMUM GRADIENT
AND WITH 1550MM x 1500MM LANDING
AREA AT ENTRY DOORS AND GATES

2. EXISTING CONTOURS SHOWN DOTTED
FOR REFERENCE ONLY

3. LOCATION OF PITS IS INDICATIVE ONLY
REFER TO STORMWATER DRAINAGE DETAILS

SITE/GROUND FLOOR PLAN

1:100

0 5 10 20 40MM
SCALE FOR PRINTING
PURPOSE ONLY



- LEGEND:**
- AB ADJUSTABLE BENCH
 - AC ALUMINIUM LOUVRES
 - B BROOM CUPBOARD
 - C CONCRETE
 - CC1 COLORED CONCRETE 1
 - CC2 COLORED CONCRETE 2
 - CF COLORBOND FENCE 1800mm HIGH
 - CL CLOTHES LINE
 - CP CARPET
 - CT CERAMIC TILES
 - G GATE
 - GD GRATED DRAIN
 - GH GAS HOT WATER UNIT
 - K CONCRETE KERB
 - L LINEN CUPBOARD
 - LB LETTER BOX
 - MF METAL FENCE 900mm HIGH
 - MF1 METAL SLATTING FENCE 1800mm HIGH
 - P PANTRY
 - P.O.S. PRIVATE OPEN SPACE
 - PS PRIVACY SCREEN
 - QT QUARRY TILES
 - REF REFRIGERATOR (BY TENANT)
 - SP STEEL POST
 - WM WASHING MACHINE
 - WR WARDROBE

Bosix Commitments:

1. Cavity brick construction throughout and reverse brick veneer with external cladding + R1.0 bulk insulation where noted mc on elevations.
2. Wafflepod slab to ground floor, suspended concrete slab to first floor units.
3. Single glazed clear skylights over upstairs bathrooms
4. Single glazed aluminium framed windows & external glazed doors (u-value < 6.88, SHGC =0.75,
5. R3.5 ceiling insulation to all first floor units
6. Foil + R1.0 roof insulation under medium colour metal roof
7. 30,000L{min} rainwater tank collecting 100% roof area and used for flushing all toilets & for garden irrigation
8. 3 star {min} rated taps, toilets & showerheads throughout
9. 5 star instantaneous gas HWS to all units
10. Ceiling fans to living areas
11. Mechanical ventilation of all kitchen and bathrooms, externally ducted
12. Energy efficient lighting through
13. Fixed outdoor clothes line to ground floor units
14. Fixed sheltered clothes line to first floor units
15. Gas cooktop & electric oven to all units
16. Compact fluoro lighting to all internal common areas, with daylight and motion sensors

1.

FIRST FLOOR PLAN

1:100